

COMPONENT OPTIONS

VIDEO DETECTION FOR ACTUATION

NON-INTRUSIVE TRUE PRESENCE DETECTION



Horizon Portable Traffic Signals have been engineered to be component based systems. Add-On components are available to enable designers and engineers to meet their specific project requirements.

Video Detection Systems offered by Horizon Signal Technologies for traffic actuation combine performance, functionality and ease of use to provide non-intrusive true presence detection. Highly sophisticated algorithms ensure accurate detection zones that can be configured to meet site specific requirements.

- True presence detection
- Non-intrusive above ground installation
- Flexible detection zone placement
- Multi-zone detection capability
- Easy Installation and configuration
- Optional Windows® based programming
- Heavy duty construction for maximum service life



How It Works

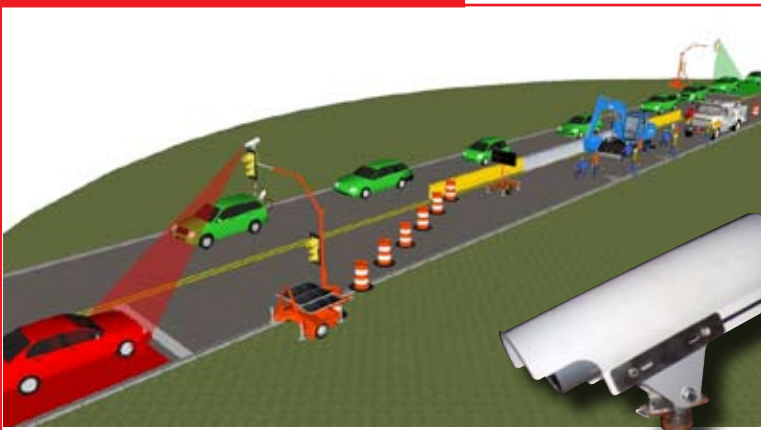

The Video Detection System consists of a camera and processor system. The camera features high resolution, remote zooms, and focus functions. It is also equipped with a high sensitivity color imager to ensure accurate vehicle detection regardless of lighting conditions. The sophisticated processor helps ensure reliable true presence detection.

Non-intrusive detection zones are configured during the system setup process by utilizing the video imaging screen to determine the detection zone placement. After the detection zones have been created and placed in the traffic lanes, the system quickly learns the configuration, and begins real-time true presence detection.

OTHER OPTIONS



Pre-emption System

The Pre-Emption System provides a green phase in the direction of an approaching emergency vehicle. Indication lights will confirm the system is functioning. Actuation is accomplished through optical communication.



Wireless Interface System

Allows a Horizon Signal System to be connected wirelessly to and operated by a standard street corner controller. Allows for a quick and easy temporary signal replacement in the event of a signal knockdown or any event to cause a permanent signal to fail. Temporary signal can be connected to a controller in under 30 minutes.



Pedestrian Signals

Pedestrian Signals can be added to the SQ3TS trailer mounted signal system or the SQ2 cart mounted signal system. They can also be used as a stand alone cart mounted indication for flexible placement. Horizon pedestrian signals conform to MUTCD Standards and are available with a push button actuation.



Remote Monitoring System

Allows an authorized user to monitor any Horizon Signal System's location, battery voltage, operating hours and system default from any internet enable source. The RMS will also send authorized users text messages / e-mail alerts in the event a signal is moved, battery voltage is low or if there is an interruption in communication.



Pilot Car / Flagger Module

Allows a pilot car driver to operate the Horizon signal system remotely using a hand held transmitter. The operator can provide a green indication to a phase of traffic for a pre-prescribed time, after which the signal reverts to an unlimited red indication.

General specifications for Video Actuation Systems are subject to change without notice to reflect improvements and upgrades. Additional information is available. Contact Horizon Signal Technologies for details.



Horizon Signal Technologies

202 Conestoga Road
Wayne, PA 19087
(610) 687-8975

Regional Distribution Centers

- Philadelphia, PA
- Chicago, IL
- Waco, TX
- Cambridge, ON
- Nationwide Local Distribution Network

www.HorizonSignal.com

DISTRIBUTED BY:

